



DHFS Transition Y6/7 2026



Baggaley



Buxton



Fanshawe



Dronfield Henry Fanshawe School Transition 2026



Gosforth

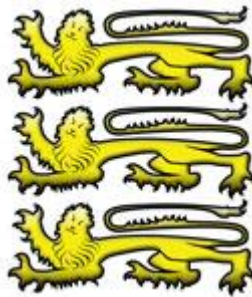

Millican



Spaven



DHFS – ‘Success with care’

School History

From the foundation of the original Henry Fanshawe School in 1579 by Thomas Fanshawe, education in Dronfield has seen many changes, many successes and some setbacks.

At the beginning of the 21st century, Dronfield Henry Fanshawe School can look back over many years with pride, and look to the future with confidence.



Mr M. Cooper
Headteacher



Mrs T. Davies
Deputy Headteacher

School Houses

For hundreds of years, DHFS had a House system. Following a 30-year absence, a House system was re-introduced in 2011; the original four Houses (Fanshawe, Baggaley, Spaven and Millican) were joined by two new ones (Buxton and Gosforth) to reflect the school's more recent history.

House Teams

A student's academic progress and wellbeing are monitored and supported by a team of staff including a House Progress Leader (they focus on your academic progress), a House Support Manager (they focus on supporting pastoral issues, attendance and behaviour) and House Mentors (they have daily contact with you and will focus on effective advice and guidance). This team is also supported by House Academic Mentors and Learning and Safeguarding Mentors.



DHFS Transition Y6/7 2026

Pastoral support at DHFS

BAGGALEY



House Support Manager
(HSM)

Mrs V. Hardwick

House Progress Leader
(HPL)

Mr D. Sanderson

BUXTON



House Support Manager
(HSM)

Miss L. Coles

House Progress Leader
(HPL)

Mrs R. Houldsworth

FANSHAWE



House Support Manager
(HSM)

Mrs A. Goodison

House Progress Leader
(HPL)

Mr B. Swales

GOSFORTH



House Support Manager
(HSM)

Miss C. Wall

House Progress Leader
(HPL)

Miss K. Luke

MILLICAN

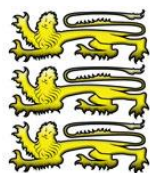

House Support Manager
(HSM)

Mr D. Wileman

House Progress Leader
(HPL)

Mr P. Varley

SPAVEN



House Support Manager
(HSM)

Mrs M. Backhouse

House Progress Leader
(HPL)

Mr A. Hibbert



House Mentor Groups

Fifteen minutes of every school day is spent with your mentor group. This “family” of students will be from the same House with approximately 6 students from each year group (years 7 to 11) and approximately 6 Sixth Form students. Led by two staff members, each mentor group will focus on providing pastoral support and effective advice and guidance.

The vertical family arrangements help Year 7s make a better transition to secondary school because from the outset they get to know older students who assist them in familiarising themselves with the school and daily routines. The same staff members will support students as they go through school. At teacher assessment points, mentors will be able to provide excellent one-to-one advice and guidance because there will only be approximately 5 students from that year group to mentor. Mentor groups will provide “peer mentoring” and “buddy reading” where younger students can learn from older students.

What can I do for my House?

Attend school every day and to be punctual. School minimum attendance target 95%.

Collect House Points:

- Achievement points (+ House Points)
- Behaviour points (- House Points)

Compete in sports and non-sports competitions

- Throughout the year, a range of House competitions take place. These are across all faculty areas for all year groups and occur at regular intervals.
- Sports, Creative, Challenges, Attendance, Events.

Cheer on your House teams in sports and non-sports competition.

Be Responsible, Reflective and Resilient (in line with DHFS 3Rs), as well as respectful, caring and polite.



People in school who can help me



Ms J. Stubbs
Assistant Headteacher
Safeguarding and Inclusion



Archie
Canine Concern Care
Dog



Mrs L. Byrd
Student Wellbeing Advocate



Mr M. Bailey
Lead Teaching Assistant



Mrs S. Ingham
Emotional Literacy Support
Assistant



Mrs E. Martins
Lead Learning and
Safeguarding Mentor



Mrs F. Hulley
Student Support



Mrs S. Wyles
Transition Lead & Pupil Premium
Mentor



Student Services

Mrs S. Burns



Mrs R. Davies



Mrs Burns and Mrs Davies work in Student Services– you come here if you:

- have an accident or feel poorly
- need to sign in late
- leave school for an appointment
- lose your house badge
- need to contact home
- report an incident

Reception



Ms G. Millington



Mrs T. Philips



Miss C. Goss

Ms Millington, Mrs Phillips and Miss Goss work on Reception – you come here if you:

- are meeting a member of staff first thing in the morning
- are signing out of school for an appointment
- arrive in school late
- have lost something.



School Day

You will move to different classrooms for lessons and have different teachers for each subject.

Mentor time: 9:00am-9:15am
 Period 1: 9:15am-10:15am
 Break time: 10:15am-10:30am
 Period 2: 10:30am-11:30am
 Period 3: 11:30am-12:30pm
 Lunch time: 12:30pm-1:30pm
 Period 4: 1:30pm-2:30pm
 Period 5: 2:30pm-3:30pm
 Home time: 3:30pm

Two-Week Timetable

	Reg	1	2	3	LUN	4	5
Mon	GO8/Rg F3	7D/Te4 JTA E23	7D/Te4 JTA E23	7D/Co3 PBA A13		7D/Sc3 RWE A15	7D/En3 SMO A8
	Tue	GO8/Rg F3	7D/Sc3 AJO E8	7D/En3 SMO A8	7D/Te4 JTA E23		7Db/Pc1 AHI
Wed		GO8/Rg F3	7C/Ma6 JCA F15	SS2/Wed:2 SWY C21	7D/En3 SMO A8		7D/Mu3 RHO F12
	Thu	GO8/Rg F3	7D/En3 SMO A8	7D/Sp3 CGR A5	7D/Dr3 JPA FD1		7D/Gg3 RTH C8
Fri		GO8/Rg F3	7D/Sc3 RWE F3	SS1/Fri:2 CWO	7D/Ar3 GDE F24		7C/Ma6 LGO C13

This is a copy of what your timetable could look like.

It tells you the:
 -Room number
 -Teacher's initials
 -The subject

The subject abbreviations are below

7Dd/Ar3=Art SS2/Wed2= Catch up lesson 7D/Co3=Computing 7Db/Pc1=Core PE 7D/Co3=Computing
 7D/Dr3 = Drama 7D//En3=English 7D/Gg3=Geography 7C/Ma6=Maths 7D/Mu3=Music
 7D/SC3 = Science 7D/Sp3 = Spanish 7D/TE4= Technology

Fire alarm and lock-down.

There is a different sound for the fire alarm and lock-down alarm.
 At the beginning of each term the lock-down alarm is tested so that you are aware of the sound it makes.
 Follow the instructions of a member of staff during a fire alarm and during lock down.



Lunchtime

At lunch time you can choose between having a school lunch or bring a packed lunch from home.

If you choose a school lunch you can...

- Go to Henry's Diner where you will queue up, choose your food, pay using your dinner card and sit down at a table to eat with other students.
- Use the Grab and Go where you can get sandwiches, pizza, paninis etc. You order pizzas/paninis from the catering staff before school or at break time. You can eat this food in Fanshawe Diner (by the Grab and Go) or in the canopy area outside.
- You pay for school meals with a dinner card. You can't pay for your dinner with cash, so please make sure your dinner card is topped up.



If you bring a packed lunch from home, you can eat it...

- In Fanshawe Diner after 1pm
- In allocated classrooms (including Lunch Club) when the weather is poor
- Under the canopy area
- **You cannot eat in corridors**





Free time at break and lunch time

There are lots of things you can do at break time and lunchtime. Clubs and organised activities are advertised on Student Notices in mentor time.

Lunch Club

Lunch Club is a friendly and supportive place to go. It is in Mrs Hulley's classroom next to Student Services.

- Teaching Assistants are there every lunch time to help you with your homework if you need it.
- You can make friends with other students.
- You can play games or if you prefer, do something on your own such as read a book.





School Planner

When you start at DHFS you will be given a Planner.

Your planner is important because it is where you will record your school timetable and your homework.

You need to get your planner signed every week by your parent/carer.

Your timetable tells you...

- Which lesson you have e.g. maths
- When it is e.g. Tuesday Period 2
- Where it is e.g. F17

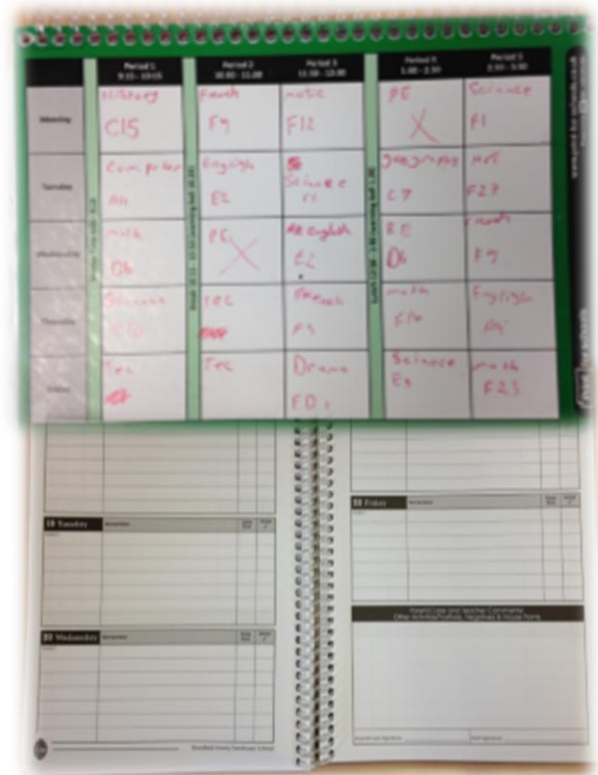

- You need to write your homework in your planner on the day that it is set.
- You also need to write the date that is due to be completed by.
- If you find this difficult, ask your teacher or a teaching assistant for support.
- If you are stuck on homework, email your teachers.



Class Charts (Students)

In one of your first mentor periods when you join the school, your mentor will give you instructions on how to access ClassCharts.

They might look like this, with the code to put into the login page on www.classcharts.com:

Demo Pupil Group Demo Group	
Keep up to date with your behaviour	
LOG IN GUIDE	STUDENT ACCESS CODE
1. Go to www.classcharts.com/student/login 2. Enter your student access code, remember to keep this safe! 3. Click Log-in!	

ClassCharts allows you to track your progress as a pupil throughout your time at DHFS, including:

- Your behaviour record;
- Any announcements the school makes to you (from Non-Uniform Days to Careers Advice);
- Your upcoming Homework;
- Any Detentions you might have;
- Your Timetable, and;
- Your Attendance Record.

ClassCharts can be accessed through your web browser (eg. Edge, Chrome, Safari). The ClassCharts app can also be downloaded and installed onto your mobile.

If you forget or lose track of the code you use to log into ClassCharts, the IT Team in the Network Office in A-Block can find it for you.

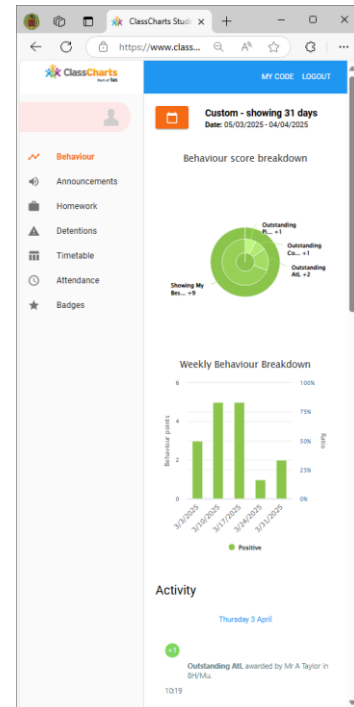



Homework

As well as tracking your pupil data, ClassCharts can also be used to see what homeworks you've been set by your teachers:

- To do;
- Completed;
- Submitted late;
- Not Submitted
- Submitted

You can also sort by when homework tasks were set by your teacher, or when they're due by.

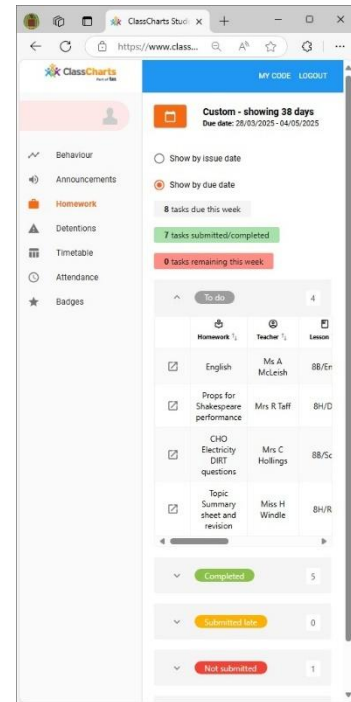

When you select one of the homework tasks you've been set, you can see:

- Who set it;
- The class it's for;
- The issue date;
- The due date;
- And the description of the homework that your teacher's left for you.

You can also tick 'Completed' to mark it off and move it out of your 'To-Do' section.

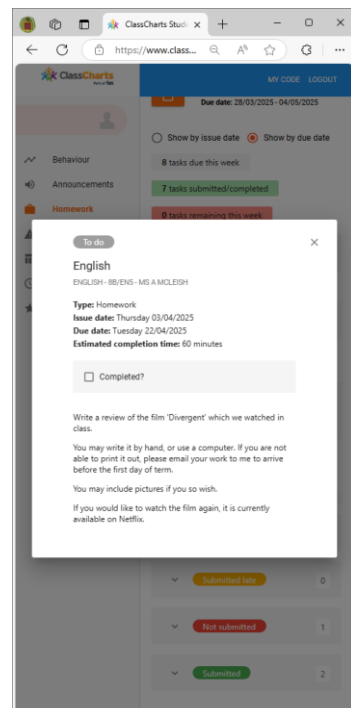



Journey to and around school

Bus

There are several contract and public buses that serve the school.

Do you know where the nearest bus stop is to your house?

How long will it take you to walk there?

What number bus you need to catch?

You must show the driver your bus pass when getting onto the bus before every journey.

If you live less than three miles from the school you may still catch a service bus, but will have to pay the usual fare. Remember to take your bus fare every day.

Walking

Can you walk to school with friends? Can you rehearse the route with them or your parents/carers?

How long will it take you to walk?

Students crossing Green Lane should always use the pelican crossing. Students crossing Chesterfield Road at Dronfield bottom should always use the Zebra Crossing

Cycling

Can you cycle to school?

Do you know the route? How long will it take?

Have you passed the 'Cycle Proficiency Test' or similar, and have you rehearsed the route? Cyclists must wear a helmet and should bring their own lock.

Dropped-off / picked-up by car -

Do you know where you are being picked up from? – The railway turning circle or Greendale shopping area? Who is picking you up?

Parents/Carers are not permitted onto the school site to pick up their child from school by car unless permission has been requested and agreed.



Floor Plans

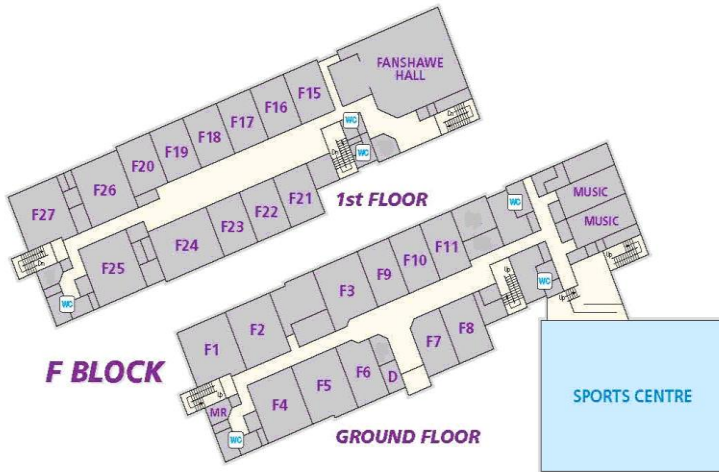

Subjects	Block	Rooms
Art	F	24-27
Careers	A	3
Drama	F	Fanshawe Hall
English	A	8-9
English	E	1-7
Humanities	C	1,6-18
Humanities	M	HM1, HM2
ICT / PSE	A	10-16
Library / Resource Centre	D	
Mathematics	F	15-23
Modern Foreign Languages	F	6-11
Music	F	Music
Physical Education	F	Sports Centre
Science	D	1,4-6
Science	E	8-13
Science	F	1-5
Technology	E	14-22, T1
Vocational Education	C	9-11

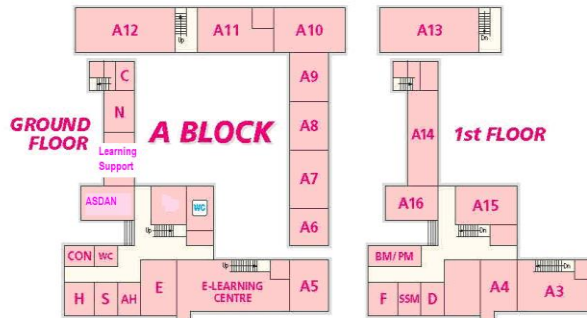
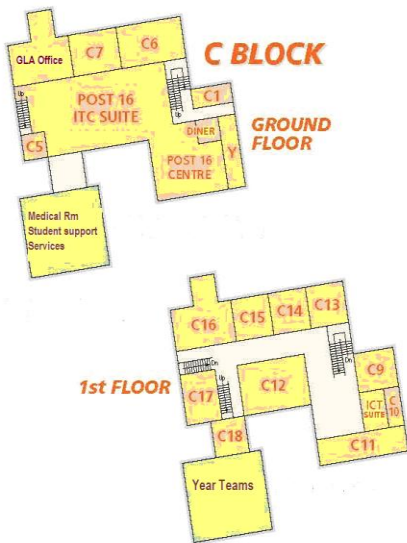
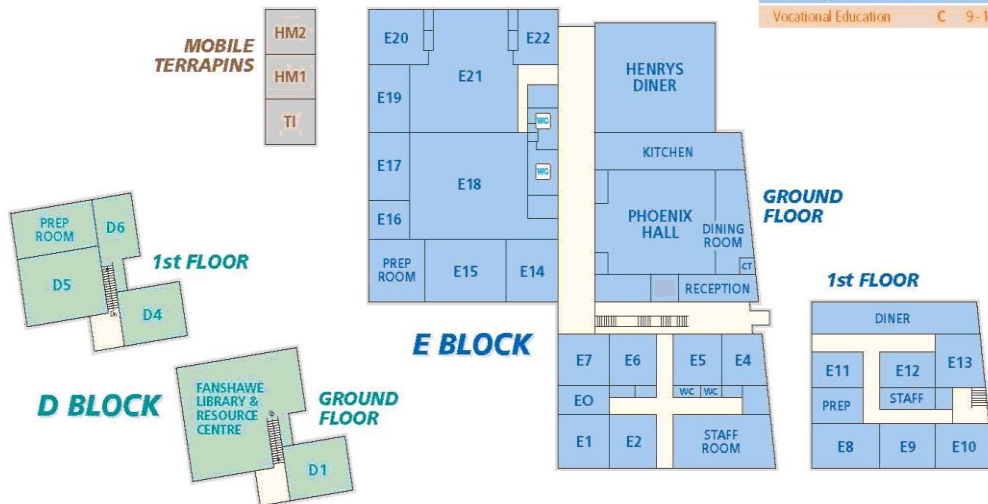

Administration	Ref.	Administration	Ref.	Administration	Ref.
Headteacher	H	School Secretary	S	Premises Manager	PM
Deputy Heads Office	D	Year Offices	Y	Caretakers	CT
Assistant Head	AH	Network Office	N	Medical Room	MR
Examination Office	E	Conference Room	CON	Support Staff Manager	SSM
Finance Office	F	Business Manager	BM	Reprographics	A6



Uniform and Appearance expectations

Uniform is compulsory for all students in Years 7 to 11 inclusive.

- A House and Year Group lapel badge will be provided and must be worn on the blazer lapel at all times. If lost, then students will be expected to buy a replacement (£1) from Students Services.
- Jewellery and piercings: should be kept to a **minimum**; a watch, only one simple ring, no bracelets, and one pair of plain stud earrings worn in the earlobes, with no other visible piercings; including stretchers, tunnels, or spiked earrings, tongue piercings, and facial piercings.
- Nail varnish, false nails, acrylic nails, henna and false eyelashes are not allowed. Students wearing make-up should ensure it is light in application and not noticeable.
- Hair should not be extreme in terms of style, cuts or colour. Lines should not be shaved into the hair and hair should be of a 'natural' colour. Any student with afro hair types 3a-4c may wear their hair in an appropriate protective hairstyle. The school allows the wearing of durags and protective bonnets for this type of hair.

UNIFORM



BLACK FORMAL BLAZER WITH SCHOOL CREST AND HOUSE AND YEAR LAPEL BADGE

DHFS CLIP-ON TIE

PLAIN WHITE SHORT OR LONG-SLEEVED COLLARED SHIRT; TUCKED IN AT ALL TIMES

OPTIONAL: FORMAL BLACK CARDIGAN OR V NECK SWEATER

PLAIN BLACK TAILORED FORMAL TROUSERS, FORMAL SHORTS OR SKIRT (AROUND KNEE LENGTH)

BLACK OR FLESH TIGHTS (OPTIONAL)

BLACK SOCKS

PLAIN BLACK LEATHER OR LEATHER-LOOK LOW-HEELED SHOES

COAT/GILET (OPTIONAL): MUST BE WORN OVER THE BLAZER
NO HOODIES OR TRACKSUIT TOPS

MINIMAL JEWELLERY; A WATCH, ONE SINGLE FLAT RING, ONE PAIR OF PLAIN EARLOBE STUD EARRINGS

NO NAIL VARNISH, FALSE NAILS, HENNA OR FALSE EYELASHES

UNNATURAL HAIR COLOURING, FACIAL PIERCINGS, TONGUE PIERCINGS AND OTHER VISIBLE PIERCINGS ARE PROHIBITED

PE kit



- A DHFS navy/green polo top
- Plain navy shorts or tracksuit bottoms
- Trainers and socks for the activity – clean training shoes are required for all indoor work.
- Suitable track-suit / sweat-tops may be worn outdoors (directed by the PE staff)

All students should have their complete PE kit for every PE lesson.



School Checklist

For each school day I need:

- School bag
 - Pencil case
 - Colouring crayons/felt tips
 - Calculator/ compass/protractor
 - Planner
 - Water bottle
 - Lunchbox/dinner card
 - Reading book/library book
 - P.E kit
 - Any other equipment (food tech, musical instruments)
 - Any letters to take to school?
-
- If you need help, ASK. Go to Student Services or speak to a member of staff you feel comfortable with.
 - Pack your bag the night before and to start with, ask someone else to check that you have got everything.
 - If you forget your homework or are finding it difficult, see your teacher before the lesson.
 - Check your emails regularly, sometimes your teachers will send you homework or information this way (everything you need to know about the computer system at school will be explained in your first ICT lesson).





Top Tips for surviving Secondary School!!!

Be Prepared

Look at your timetable and know where to go and when.

Be Organised

Make sure you have the right books and equipment with you.

Be Brave!

It might seem hard to make new friends, but everyone is feeling the same way

So say hello!

Be Kind!

This is a good way to make friends. If someone else seems to be having a hard time, try to help.

Be Honest!

If you do something wrong or forget something, it's much better to own up straight away.

Be Yourself!

Believe in yourself! You can do it!





Answers to Frequently Asked Questions

- There are unisex toilets in the school
- You will be able to get to school by catching a bus without your parents/carers
- If you are late for school, you may be asked to go to see a different teacher
- Your parents/carers will be informed if your behaviour is not acceptable
- You will be able to choose to stay after school and take part in a club
- You will have the opportunity to try new things
- You will be able to choose what you would like to eat for your lunch
- Your parents/carers will be invited to parents' consultation evenings to talk about how you are doing in school
- There will be different teachers for different lessons
- There will be year group and House assemblies
- You will be expected to do homework and will get homework from each different lesson. If you don't do your homework, you will be given a detention.
- Ask for help from the teacher if you don't understand and the teachers are happy to help
- You will have to find your way around the school and move from classroom to classroom for each lesson, but don't worry people are friendly and will help you if you get lost
- You will be able to go to the toilet in lesson but you have to get your teacher to sign your planner
- You will be invited to go on school trips and residential
- You can get a copy of your timetable if you lose it





DHFS Transition Y6/7 2026

All about Me

- My name is
- About me

- What makes me happy? What makes me sad?

- What I am excited about for my new school:

- What I am nervous about for my new school:

We are all looking forward to working with you! Don't worry we are all here to help you settle and start your new adventure at DHFS



DHFS Word search

Z E D I H P H V X F M T M H V M Z Q R R
G V H K N P H T I A T E C L Z Y V E K E
B E B E G D N P H N M E S C T H G P S D
H A W Z N S J E I S Z Q J V J A B T F A
Y L M L E R L N H H W V M N N E Y Y X E
B U X T O N Y G T A Z Q N A R A F Y E L
R M H W B D W S Q W N P M U B F F J I S
J E V L J S T U D E N T S E R V I C E S
P N N P W Q W J G I R A B P R K X I K E
H T R O F S O G K O N A C E A C R U D R
N O S X D M E Z P Y G E N I E V W S X G
L R V U O K W P F G Z N R J L L E D I O

Baggaley
Fanshawe
Millican
Henry's Diner
House Progress Leader
House Support Manager
Phoenix

Buxton
Gosforth
Spaven
Mentor
Planner
Student services